



Quick Start Guide

THERMION Thermal Imaging Riflescopes

ENGLISH / FRANÇAIS / DEUTSCH / ESPAÑOL / ITALIANO / РУССКИЙ

⚡ Beginning operation

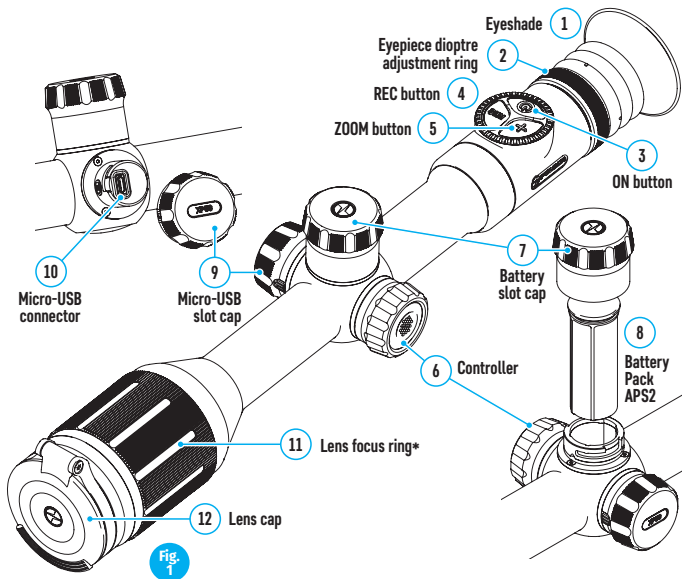

Switching on and adjusting the image

- Remove the lens cover (12). – Turn the unit on with a short press of the ON button (3).
- Adjust the resolution of the icons on the display by rotating the dioptre adjustment ring (2).
- Rotate the lens focus ring to focus on the object being observed (11)*.
- Select the desired calibration mode in the main menu: Manual (M), Semi-automatic (SA) or Automatic (A).
- Calibrate the image with a short press of the ON button (3) (where calibration mode SA or M has been selected). Close the lens cap during manual calibration.
- Adjust the brightness, display contrast, and smooth digital zoom using the Controller (6). See the 'QUICK MENU FUNCTIONS' section for more details.
- Turn the unit off with a long press of the ON button (3).



* except for Model XM30 (non-focusing lens)

⚡ Operation of buttons

Control mechanism	Condition /Operating Mode	First short press	Next short press	Long press	Rotation
ON button 	Device is powered off	Power on the device	Device calibration	Power on the device	-
	Display off	Turn on display	Device calibration	Power off the device	-
	Device turned on, quick menu, main menu	Device calibration	Display off / device powered off	-	
ZOOM button 	Device turned on, quick menu, main menu	Change magnification (Zoom)	PIP on/off	-	
REC button	Device turned on, quick menu, main menu, video mode	Begin video recording	Toggle video / photo mode	-	
	Device turned on, quick menu, main menu, video recording on	-	Stop video recording	-	
	Device turned on, quick menu, main menu, photo mode	Photographing	Toggle video / photo mode	-	
Control-ler	Device is powered on	Open quick menu	-	Open main menu	-
	Quick menu	Navigation	Exit quick menu	Change parameter	
	Main menu	Confirm value, enter menu options	Exit menu options, exit main menu	Navigation through menu	

⚡ Stream Vision App

Download the Stream Vision app to stream the image via Wi-Fi from your Thermion device to a smartphone or tablet.

Detailed instructions are available on the Internet at: www.pulsar-vision.com



⚡ Mounting on the weapon

The **Thermion** riflescope must be properly mounted on the rifle to ensure accurate shooting.

The riflescope is fixed using the mount, which is purchased separately according to the type of gun. Use only high-quality mounts and rings that are designed specifically for your gun.

The scope should be set as low as possible but should not come into contact with the barrel or receiver.

Before securing the fastening rings, ensure that the riflescope provides the necessary distancing of the exit pupil and enables you to see the full field of vision.

⚡ Charging the battery

Thermion thermal imaging riflescopes come with a built-in rechargeable lithium-ion Battery Pack APS3 with a capacity of 3200 mAh and a removable rechargeable lithium-ion APS2 Battery Pack with a capacity of 2000 mAh. The battery should be charged before first use.

- Open the microUSB cover (9) by turning it counter clockwise (Fig. 2).
- Attach the microUSB plug of the USB cable (16) to the microUSB connector (10) in the body of the riflescope.
- Attach the second microUSB plug on the USB cable (16) to the microUSB connector on the mains device (17). Plug the device into a 100–240V power outlet (18).

WARNING. When charging batteries via the microUSB connector (10) in the body casing of the riflescope, the built-in Battery Pack APS3 is the first to be charged. Once it is fully charged, the removable APS2 Battery Pack begins charging. When the device is in use, power consumption occurs in reverse order.

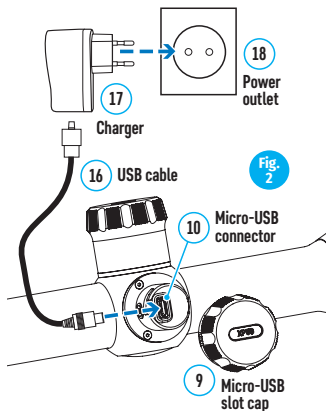

The rechargeable APS2 lithium-ion Battery Pack may be recharged using the APS* charger.

- Fully insert the APS2* rechargeable battery (8) supplied with your device, or purchased separately, along the guide rail into the APS charger slot (13) (see Fig. 3).
- Point A on the battery and Point B on the charger should be aligned.
- Two batteries** can be charged at the same time – a second slot is provided for this.
- Attach the microUSB plug on the USB cable (16) to the microUSB connector on the mains device (17). Plug the device into a 100–240V power outlet (18).